



COMPENSATORS & BELLOWS

Flexible, robust and FDA Compliant.

Our compensators provide the flexibility to eliminate misalignment issues or provide connections to process equipment with strict weighing requirements. With this in mind the manufacturing of compensators and bellows is maintained to the **highest requirements and highest quality.**

Compensators and bellows are mainly used for the final connection between transfer chutes and process equipment.

We have a complete range of injection mould tooling for the manufacture of different lengths and thicknesses of compensators and bellows. Confidence that the internal diameter of the compensator matches the process chutes eliminates the occurrence of crevices or ledges, which ensures effective WIP/ CIP without disassembling.

The material hardness is between 30 and 75 Shore. Our product range spans from DN 100 to DN 300 conforming to DIN 32676 up to DN 200 and BS 4825 up to DN 300. Compensators and bellows come as standard in FDA Compliant white and black EPDM and Viton. FDA approved Silicone can be supplied on request or for particularly aggressive duties FFKM or FFPM elastomers are available.



Conductive black compensators and bellows can also be supplied for process requirements in EX-zones which are also FDA Compliant.



All the bellows and compensators are normally fitted with a bellow flange. This can be connected directly to the customer's flange or to a TRI-Clamp adapter. For further details please refer to the drawing and table.



Bellows with a **1 mm wall thickness** can be **supplied for critical weighing applications** which require the weigh cells to be sufficiently isolated from adverse process forces. This ensures maximum flexibility, minimum interference on the weighing process and containment guaranteed.



Bellows and compensators are available in a range of lengths, diameters and thicknesses to suit all applications and are capable of filtering out unwanted movements and vibrations in both axial and lateral directions.



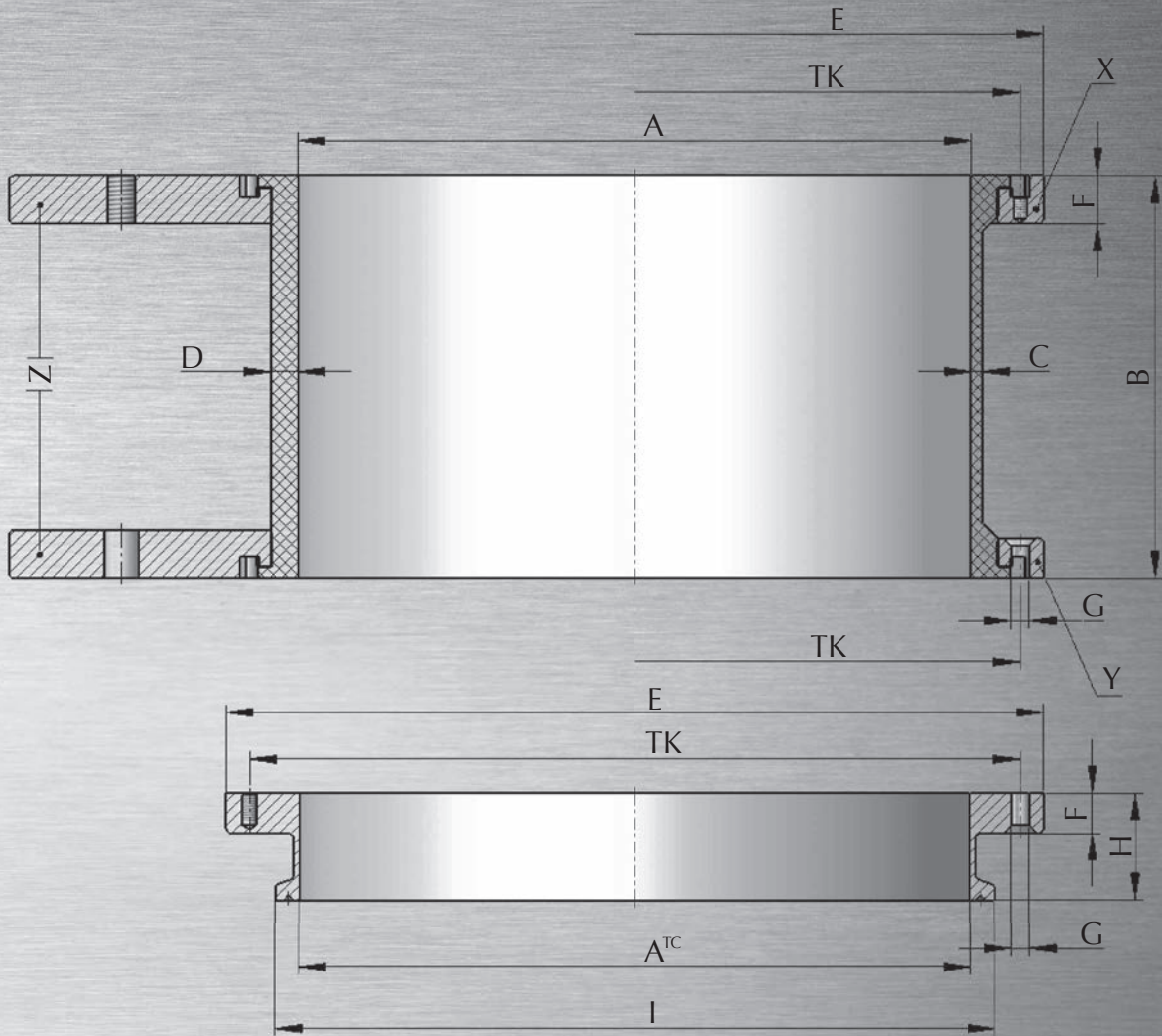

BELLOW & COMPENSATOR	MATERIAL***	BELLOWFLANGE (304) & TC (316 L)
----------------------	-------------	---------------------------------

A	B	C				D				EPDM*		VITON*		A ^{TC}	E	F	G	H	I BS 4825	TK
		1	4	8	10	white	black**	white	black**											
100	135	•				•	•	◦	◦	100/4"	152.5	12	∅6.58x45°	35	119	∅137 8xM6				
100	245	•				•	•	◦	◦	100/4"	152.5	12	∅6.58x45°	35	119	∅137 8xM6				
100	135		•			•	•	◦	◦	100/4"	152.5	12	∅6.58x45°	35	119	∅137 8xM6				
100	245		•			•	•	◦	◦	100/4"	152.5	12	∅6.58x45°	35	119	∅137 8xM6				
100	60				◦	•	•	◦	◦	100/4"	152.5	12	∅6.58x45°	35	119	∅137 8xM6				
150	135	•				•	•	◦	◦	150/6"	203.5	15	∅6.58x45°	35	167	∅186 8xM6				
150	245	•				•	•	◦	◦	150/6"	203.5	15	∅6.58x45°	35	167	∅186 8xM6				
150	135		•			•	•	◦	◦	150/6"	203.5	15	∅6.58x45°	35	167	∅186 8xM6				
150	245		•			•	•	◦	◦	150/6"	203.5	15	∅6.58x45°	35	167	∅186 8xM6				
150	60				•	•	•	◦	◦	150/6"	203.5	15	∅6.58x45°	35	167	∅186 8xM6				
200	150	•				•	•	◦	◦	200/8"	254.5	15	∅6.58x45°	35	217.7	∅232 8xM6				
200	283	•				•	•	◦	◦	200/8"	254.5	15	∅6.58x45°	35	217.7	∅232 8xM6				
200	150		•			•	•	◦	◦	200/8"	254.5	15	∅6.58x45°	35	217.7	∅232 8xM6				
200	283		•			•	•	◦	◦	200/8"	254.5	15	∅6.58x45°	35	217.7	∅232 8xM6				
200	60				•	•	•	◦	◦	200/8"	254.5	15	∅6.58x45°	35	217.7	∅232 8xM6				
250	150	•				•	•	◦	◦	250/10"	304.5	15	∅6.58x45°	40	268	∅287 8xM6				
250	283	•				•	•	◦	◦	250/10"	304.5	15	∅6.58x45°	40	268	∅287 8xM6				
250	150		•			•	•	◦	◦	250/10"	304.5	15	∅6.58x45°	40	268	∅287 8xM6				
250	283		•			•	•	◦	◦	250/10"	304.5	15	∅6.58x45°	40	268	∅287 8xM6				
250	60				•	•	•	◦	◦	250/10"	304.5	15	∅6.58x45°	40	268	∅287 8xM6				
300	145		•			•	•	◦	◦	300/12"	361.5	18	∅8.58x45°	40	319	∅341 8xM8				
300	275		•			•	•	◦	◦	300/12"	361.5	18	∅8.58x45°	40	319	∅341 8xM8				
300	70				•	•	•	◦	◦	300/12"	361.5	18	∅8.58x45°	40	319	∅341 8xM8				

* FDA Compliant	A ^{TC} DIN32676/BS4825	X flange with threadhole
** conductive	• in stock	Y clearance hole
*** other materials on request	◦ manufactured to order	Z depending on customer requirement

Our Philosophy: Perfection in the smallest detail



Andocksysteme G. Untch GmbH
Schweighofstr. 3 · 79410 Badenweiler
Tel. +49 7632 82 3 82 0
info@andocksysteme.de
www.andocksysteme.com

Sales Representative: